

# OIL PUMP DISASSEMBLY/ASSEMBLY

B3E051719220A05

1. Perform the preinspection before disassembly.

(See [Oil Pump Preinspection.](#))

2. Disassemble in the order indicated in the table.

3. Assemble in the reverse order of disassembly.

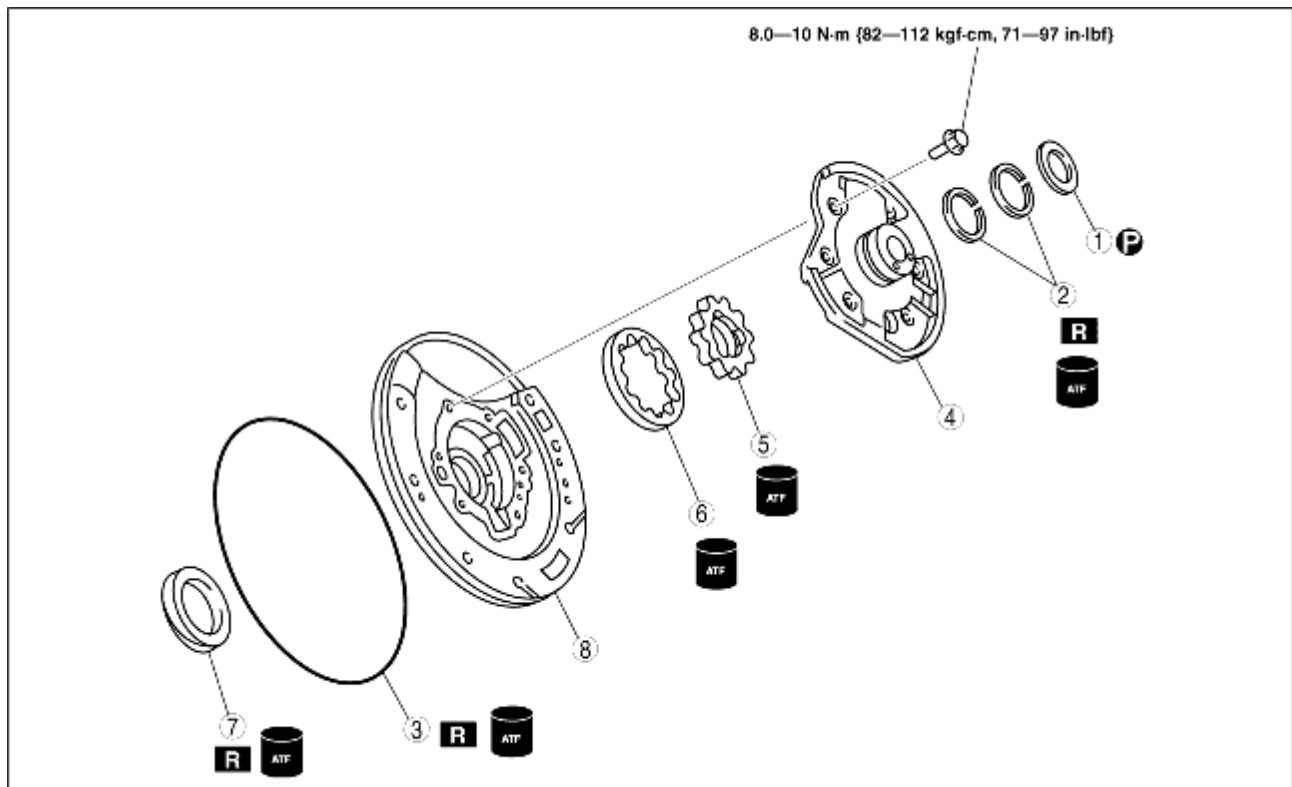

B3E0517A100

1	Thrust washer
2	Seal rings
3	O-ring
4	Oil pump cover (See <a href="#">Oil Pump Cover Disassembly Note.</a> )
5	Inner rotor (See <a href="#">Inner Rotor, Outer Rotor Disassembly Note.</a> )
6	Outer rotor (See <a href="#">Inner Rotor, Outer Rotor Disassembly Note.</a> )
7	Oil seal
8	Oil pump housing

## Oil Pump Cover Disassembly Note

- Loosen the mounting bolts evenly in the pattern shown and remove the oil pump cover from the oil pump

housing.

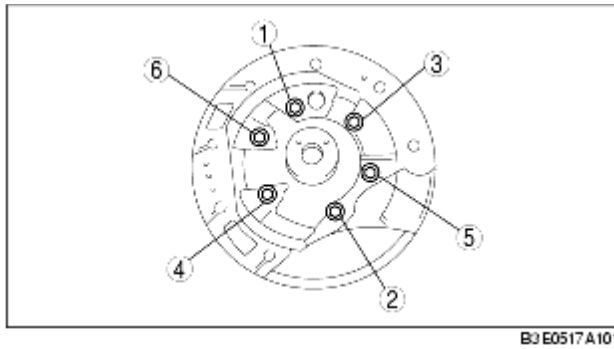

## Inner Rotor, Outer Rotor Disassembly Note

- Mark the outer and inner rotors without scratching or denting them, then remove the oil pump housing.

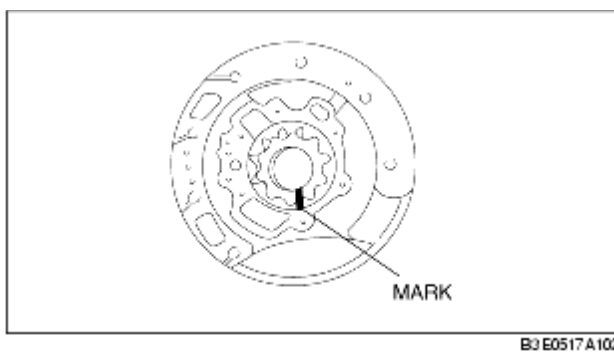

## Assembly Procedure

1. Apply ATF to new oil seal and install it onto oil pump housing using the **SST**.

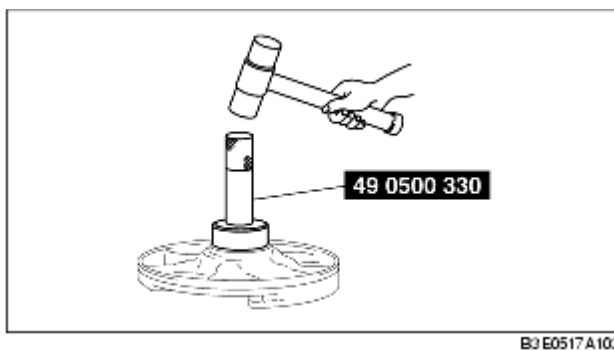

2. Measure the clearance between the end of the oil pump housing and the outer rotor and inner rotor at four places along their circumferences.

**Clearance****Standard:****0.04-0.05 mm {0.0015-0.0019 in}****Maximum:****0.06 mm {0.0023 in}**

- If not as specified, replace the oil pump.

3. Measure the clearance between the outer rotor and the inner rotor.

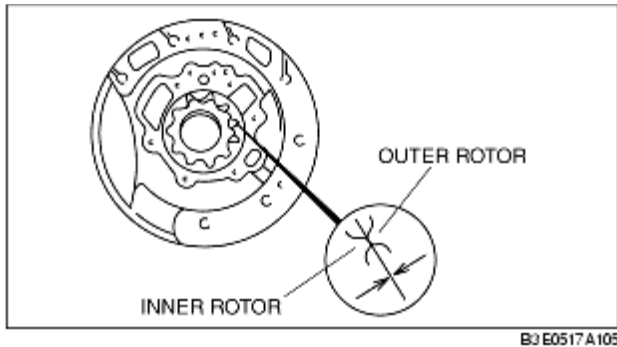
**Oil clearance****Standard:****0.02-0.13 mm {0.0008-0.0051 in}****Maximum:****0.14 mm {0.0055 in}**

- If not within the specification, replace the oil pump.

4. Apply ATF to the outer and inner rotors.

5. Align the marks and install the outer and inner rotors.

6. Install the oil pump flange.

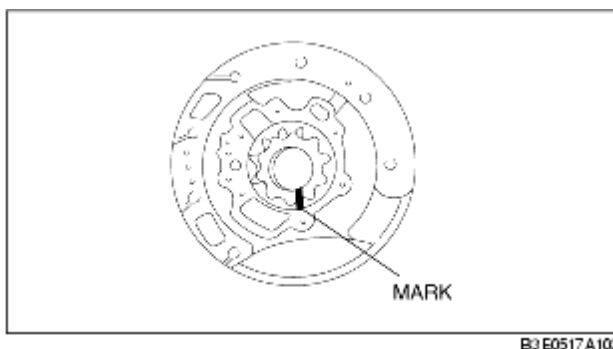

7. Mount the oil pump cover onto the oil pump housing.

8. Tighten the bolts evenly and gradually in the order shown.

**Tightening torque****8.0-10 N·m {82-112 kgf·cm, 71-97 in·lbf}**

9. Apply ATF to new O-ring and install it onto the oil pump housing.

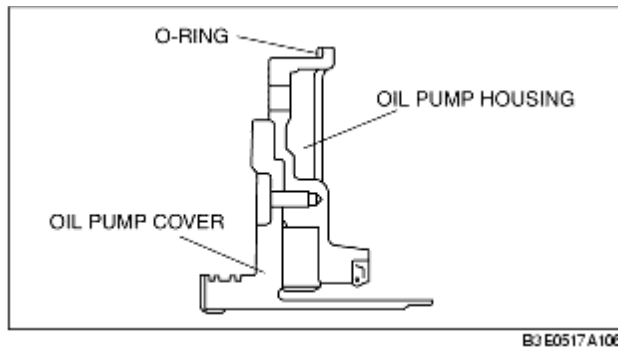
**O-ring inner diameter****209.5 mm {8.248 in}**

10. Apply ATF to new seal rings and install them onto the oil pump cover.

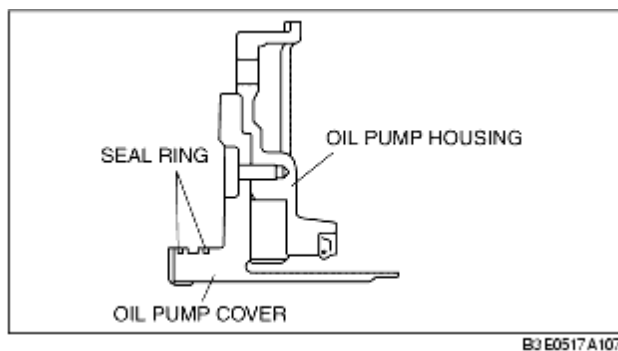
**Seal ring inner diameter****47.1 mm {1.854 in}**